

BYT15/16

Magnetic guide tube for cartridge valve

- Pull type, four-stage argon arc copper pile welding, threaded connection

BYT15-16-01

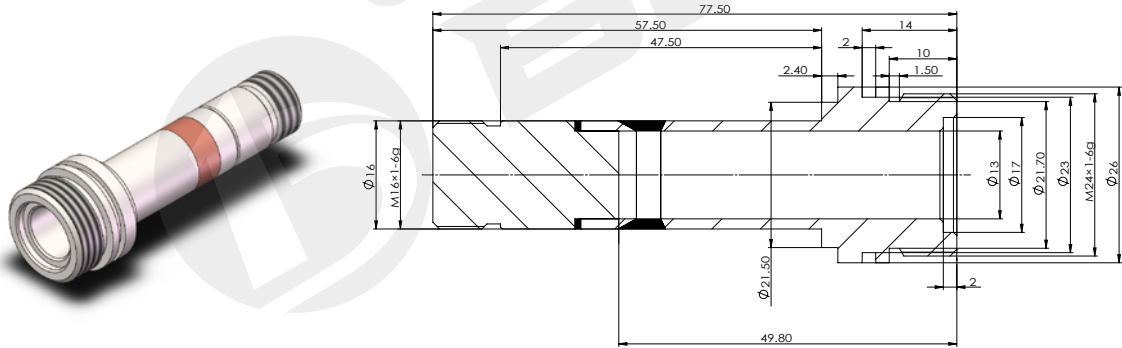

technical parameter					
Working oil pressure	MPa	≤ 21	Hexagon size	mm	—

BYT16-13-01

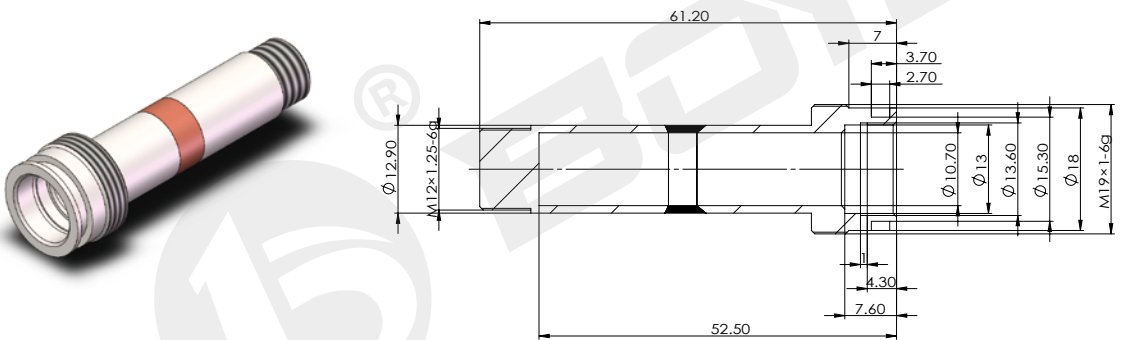

technical parameter					
Working oil pressure	MPa	≤ 21	Hexagon size	mm	—